

ESTRUTURA DO PAVIMENTO - ACESSO AO BALNEÁRIO DA CACHOEIRINHA (RUA PEDRO JOSÉ RASQUINHA)

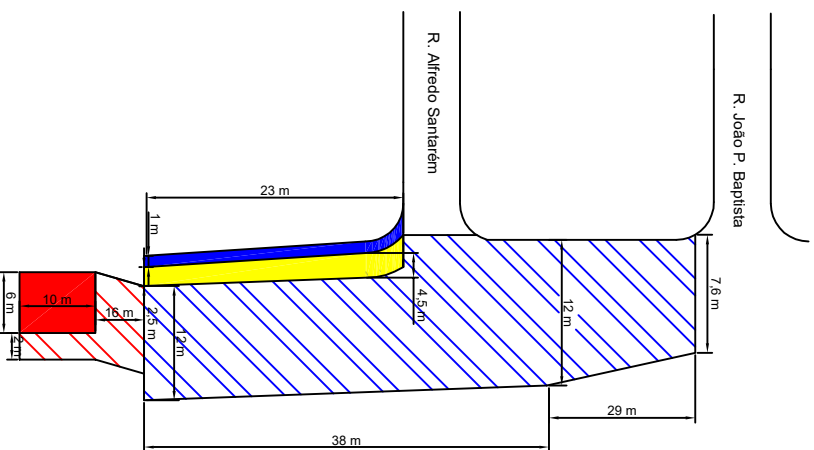

Bloco Concreto

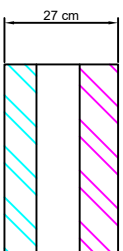

Blocos 8 cm
Colchão de areia 7 cm
Base Graduada 12 cm

Passeio em Blocos

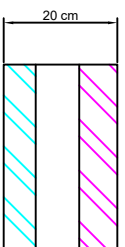



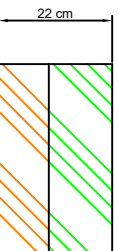

Blocos 6 cm
Colchão de areia 6 cm
Base Graduada 08 cm

Laje Concreto



Laje em Concreto de 35 mpa - E= 10cm com tela Q196
Suporte com E= 12 cm (BGS)

Legenda

-  Pavio com blocos concreto e=8cm (A= 780m²)
-  Passeio em blocos (e=06 cm) (A=92m²)
-  Trecho em solo natural (A=23m²)
-  Pavio com laje concreto (A= 150)
-  Laje de concreto existente (A= 60 m²)

Das Inclinações - Lateral 3%
Longitudinal - Conforme Terreno

Prefeitura Municipal de General Câmara - RS
Rua: General David Canabarro, 120, Centro General Câmara

Pavimentação do Acesso à Praia da Cachoeirinha	Data do Projeto: 05/ 06/ 2020
------------------------------------------------	-------------------------------

Resp. Técnico: Eng. Civil_Jordão Oliveira da Silva	Prefeito Municipal: Helton Holz Barreto
-------------------------------------------------------	--------------------------------------------